



ARCHITECTS
PLANNERS
ENGINEERS

GROUNDWORK, LTD

351 WEST DUNDEE ROAD - SUITE A
BUFFALO GROVE, ILLINOIS 60089



PHONE: 847.541.4151
FAX: 847.541.4066
WWW.GROUNDWORKLTD.COM
E-MAIL: GWORKLTD@SBCGLOBAL.NET

GROUNDWORK, LTD. Architects/Planners/Engineers was established by its principals specifically to offer services in the areas of Architectural Design, Civil Engineering, Site Planning and Contract Administration. Groundwork, Ltd. brings together individuals attuned to dealing with today's sophisticated and complex design, construction and planning problems and in developing effective, appropriate and efficient solutions meeting the client's needs. The result has been an award winning architectural and engineering firm dedicated to competent design and attention to detail.



GROUNDWORK, LTD. is a multi-disciplined combination of professional talent offering a complete design entity with offices located in Buffalo Grove, Illinois. Groundwork, Ltd. has grown to serve a wide range of clientele throughout the Northern Illinois area. Groundwork, Ltd. offers experienced, in-house professionals in architecture, land planning and civil engineering. With extensive backgrounds in residential, public design, senior housing, office, civil, commercial and land planning disciplines, the company maintains a commitment to providing the most thorough design available.

Operating under the philosophy that in today's world a building and its site comprises sophisticated, complex elements, Groundwork, Ltd. commits to developing a product where the thousands of design elements coordinate effectively with all the other pieces. The design principals of Groundwork, Ltd. bring together over 75 years of professional experience. The team of professionals at Groundwork include:

THE TEAM LEADERS

John P. Green, AIA, NCARB, Principal and Director of Planning Services. In addition to his land planning skills, John, a licensed architect since 1977, has three decades of experience in architectural design with administrative and direction responsibilities. Since graduating from the Illinois Institute of Technology in 1973, John has become recognized as an expert regarding building and zoning code ramifications over a wide variety of local and national codes and ordinances. His affiliations have included: National Council of Architectural Registration Boards Certified; Rotary Club of Buffalo Grove; Friends of the Parks Foundation, Buffalo Grove (President); American Institute of Architects; Buffalo Grove Chamber of Commerce Board of Directors; and Mount Prospect Zoning Board of Appeals (1982-87).

David Wytmar, AIA, LEED AP, began his professional working career with Groundwork, Ltd. as one of the first architectural staff professionals. Today he is a President and Director of Architectural Design for the company. David received his Master of Architecture from the University of Oregon. He has now assumed responsibility for architectural design, production and coordination from feasibility study through contract administration. David remains an active member of the American Institute of Architects (AIA), the Home Builder's Association of Greater Chicago, and the Self-Storage Association.

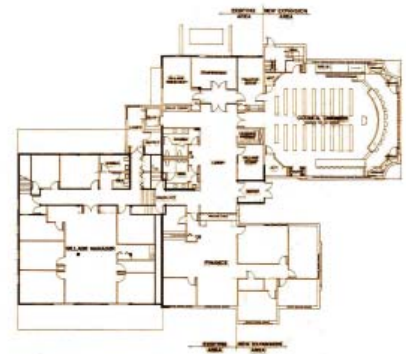

Concept Site Plan

Mark Chertow, P.E., registered in both Illinois and Indiana, serves Groundwork, Ltd. as Director of Civil Engineering. He brings over thirty years of experience in civil engineering design with project management responsibilities to Groundwork, Ltd. He is responsible for site investigation; preliminary feasibility studies; civil engineering for residential, commercial, industrial and municipal sites; and coordination of final engineering plans. Mark's expertise extends into interdisciplinary project coordination of civil engineering with land planning, and sanitary/stormwater management. Mark's affiliations include: service as Program Chairman for the American Society of Civil Engineers, Leader of Water Resources Division and service on the Board of Directors. Mark is also a member of the U.S. Coast Guard Auxiliary.

REPRESENTATIVE PROJECTS

Site Planning and Site Engineering design services for a variety of the Sunrise Assisted Living Facilities in Illinois including: concept planning; public hearing processing; preliminary and final site engineering; process coordination; and promotional plan development.



The indoor inline-skating and hockey facility portion of the 2001 IRPA award winning 54,000 Sq. Ft. Mount Prospect Park District Central Community Center in Mount Prospect, IL.

Design of 140 single family units on a 60 acre site including: concept plans; zoning; public hearings; park site design; standard, custom and semi-custom home designs; and construction documents.

Design of 58 single-family condominium units and two 36 unit condominium buildings for 14 acre development including: site planning; bike and pedestrian path design; municipal golf course improvements and cart paths; pedestrian bridges; detention pond design; construction document preparation.

Village wide survey of curbs, sidewalks and bike paths for compliance with ADA accessibility requirements. Reported conditions and recommended improvements for implementation by the several local governments in northeast Illinois.

Planning, Civil Engineering and Architectural Design Services for creation of a 56,000 S.F. recreational center and centralized administrative offices for the Mount Prospect Park District.

Lake County Highway Improvement Plans for right and left turn lanes on Weiland Road, 3000 LF roadway horizontal and vertical geometry and storm drainage design. Over 1000 LF bike path design, park site design, pedestrian bridge and streetlighting, and improvements for subdivision of 114 single family units.

Architects for the Village Hall of the Village of Buffalo Grove, Illinois and its various expansions and additions, including the design of the interiors and space planning for: the Council Chamber; Village Manager's Offices; and the Departments of Building, Zoning, Planning and Finance.

Designs of a variety of special and unique custom homes with up to 15,000 square feet of habitable area and valued at between \$800,000 to \$2,500,000 in premium communities such as: Bannockburn, Illinois; Scottsdale, Arizona; Northbrook, Illinois; Beverly Shores, Indiana; Lake Geneva, Wisconsin; and Highland Park, Illinois.

Architectural services for a range of commercial projects spanning from self-storage mini-warehousing facilities on multiple sites from 3 to 10 acres to the former Ditka's restaurant at the O'Hare Plaza office complex to restaurant activity, and banquet/conference facilities in Buffalo Grove, Wheeling, and Mount Prospect, Illinois.



BUSINESS AND PROFESSIONAL REFERENCES

PARK DISTRICT EXECUTIVE DIRECTOR (RETIRED)
Mount Prospect, Illinois

MAYTAV, INC.
Chicago, Illinois

JVC LLC
Elgin, Illinois

MT. PROSPECT PARK DISTRICT
Mount Prospect, Illinois

PARK DISTRICT EXECUTIVE DIRECTOR (RETIRED)
Buffalo Grove, Illinois

DKI, INC
Chicago, Illinois

HARRIS BANK, BARRINGTON
Barrington, Illinois

HOWARD S. CHEZ & ASSOCIATES
Skokie, Illinois

WLB, LLC
Arlington Heights, Illinois

BANNER ACQUISITIONS LLC
Northbrook, Illinois

CONTACT

Mr. Walter Cook
847/542-7986

Mr. David Neiman
773/761-6700

Mr. Joe Vargo
224/217-2043

Mr. Jim Jarog
847/590-4011

Mr. Mike Rylko
847/804-7335

Mr. Timothy Hedges
312/255-9986

Ms. Jane Brink-Tunison
847/756-5720

Mr. Howard Chez
847/983-0727

Mr. William Balling
847/398-8399

Mr. Chris Hooker
847/656-5730



ARCHITECTS • PLANNERS • ENGINEERS
351 WEST DUNDEE ROAD - SUITE A
BUFFALO GROVE, ILLINOIS 60089
847.541.4151 - FAX 847.541.4066
WWW.GROUNDWORKLTD.COM